

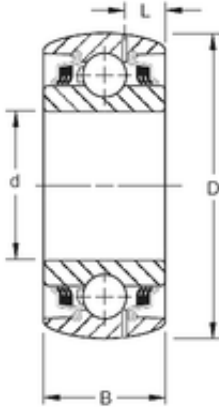

Jinan Longli Hydraulic Device Co., Ltd.

ROUND BORE



49,23 mm x 90 mm x 30,18 mm TIMKEN
GW210PPB2 Single Row Ball Bearings

Bearing No. GW210PPB2

Size	49.23x90x30.18 mm
Bore Diameter	49,23 mm
Outer Diameter	90 mm
Width	30,18 mm
d	49,23 mm
D	90 mm
B	30,18 mm
C	30,18 mm
Weight	0,681 Kg
Basic dynamic load rating (C)	39,9 kN

GW210PPB2 Bearing 2D drawings and 3D CAD models